

Master Closet

Woodgrain melamine

Deco "B" edges on doors and
moulding

5/8" subtop only, Granite top by
other.

Include 2 lucite double tray jewelry
drawers with velvet bottom
compartment in extra space.

Suspend center two upper cabinets in
Island to ceiling trusses

Wood framed, clear glass doors.



Customer Signature: _____



Design Team: Jay and Debbie Ward

Factory Showroom

5030 W. Oquendo Rd., Suite 100, Las Vegas, NV 89118

Office: 739-0000 * Cell: 327-2319 * Fax: 645-2474

Dave and Kathy Oder

Sheet 2 of 17

Master Closet

Her side wardrobe and shoes



Customer Signature: _____



Design Team: Jay and Debbie Ward

Factory Showroom

5030 W. Oquendo Rd., Suite 100, Las Vegas, NV 89118

Office: 739-0000 * Cell: 327-2319 * Fax: 645-2474

Print Date: 05/13/06 J

Dave and Kathy Oder

Sheet 3 of 17

Master Closet

Her side Drawers and cabinets

Shown with mirror closed



Customer Signature: _____



Design Team: Jay and Debbie Ward

Factory Showroom

5030 W. Oquendo Rd., Suite 100, Las Vegas, NV 89118

Office: 739-0000 * Cell: 327-2319 * Fax: 645-2474

Print Date: 05/13/06 J

Dave and Kathy Oder

Sheet 4 of 17

Master Closet

His side Drawers and cabinets

Shown with mirror open



Customer Signature: _____



Design Team: Jay and Debbie Ward

Factory Showroom

5030 W. Oquendo Rd., Suite 100, Las Vegas, NV 89118

Office: 739-0000 * Cell: 327-2319 * Fax: 645-2474

Print Date: 05/13/06 J

Dave and Kathy Oder

Sheet 5 of 17

Master Closet

His side Wardrobe and shoeshelves

Cabinets to be 28" deep

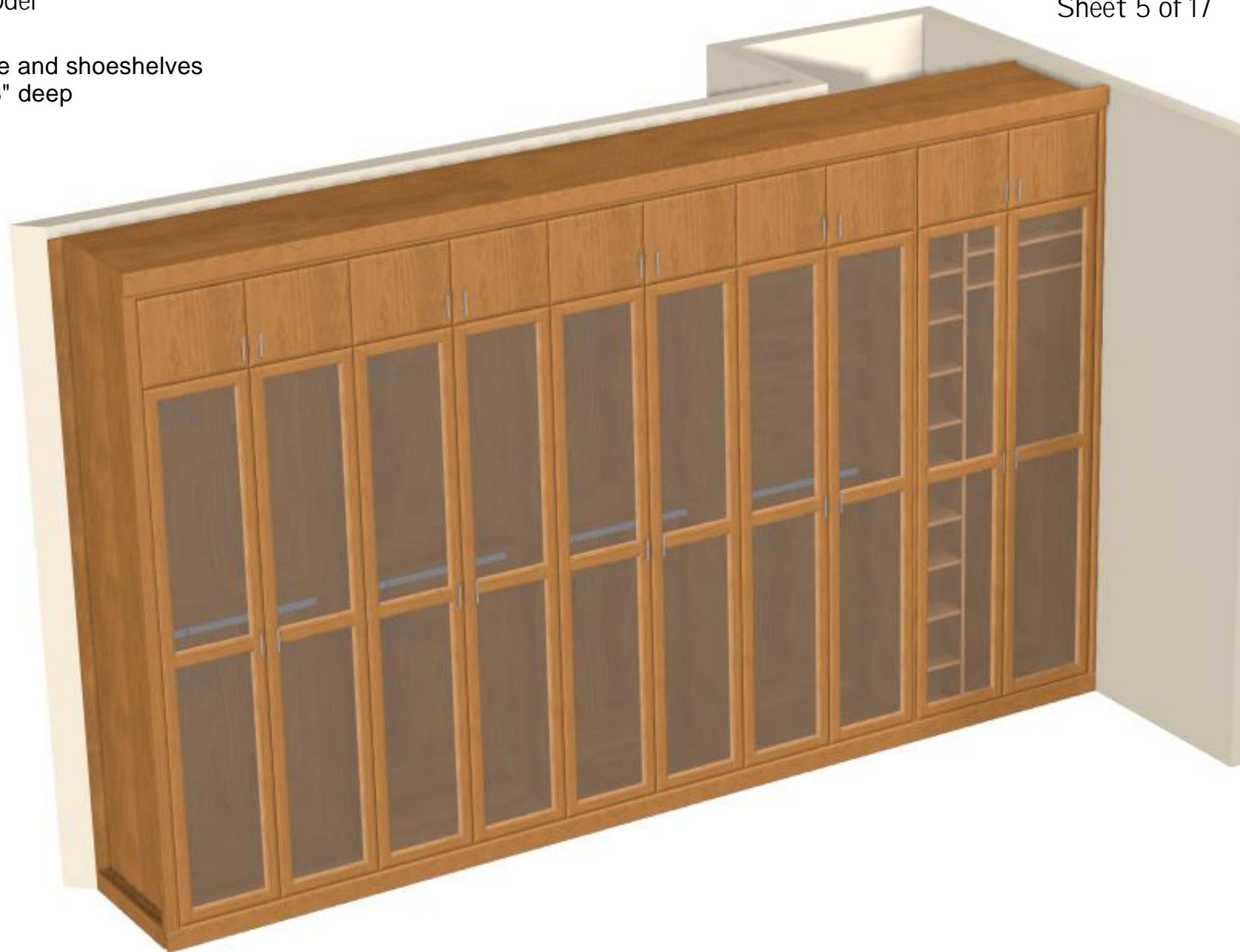

Customer Signature: _____



Design Team: Jay and Debbie Ward

Factory Showroom

5030 W. Oquendo Rd., Suite 100, Las Vegas, NV 89118

Office: 739-0000 * Cell: 327-2319 * Fax: 645-2474

Print Date: 05/13/06 J

Dave and Kathy Oder

Master Closet

Woodgrain melamine

Deco "B" edges on doors and moulding

5/8" subtop only, Granite top by other.

Include 2 lucite double tray jewelry drawers with velvet bottom compartment in extra space.

Suspend center two upper cabinets in Island to ceiling, (These 2 are no backs)

Wood framed, clear glass doors.

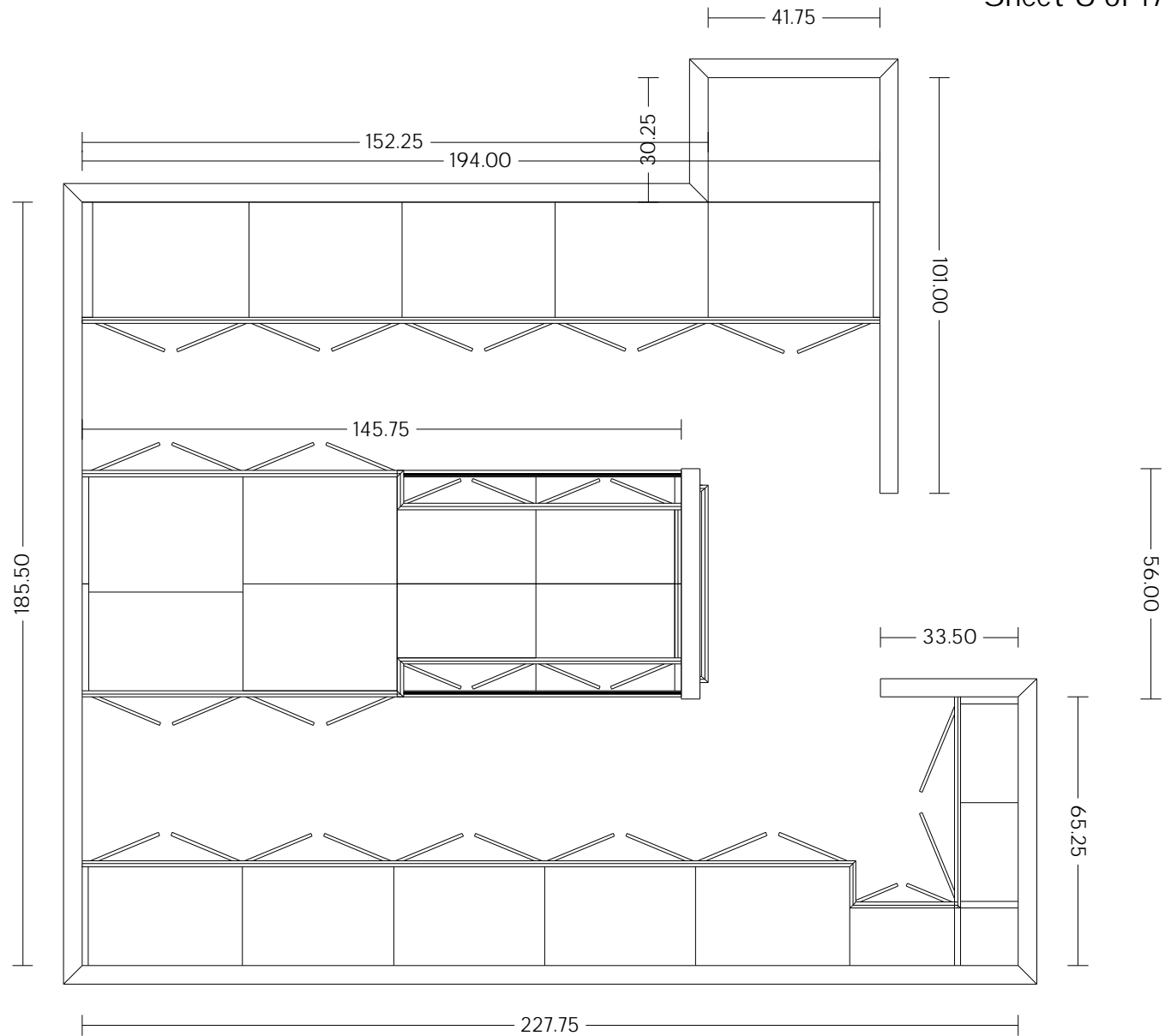

Customer Signature: _____



Design Team: Jay and Debbie Ward

Factory Showroom

5030 W. Oquendo Rd., Suite 100, Las Vegas, NV 89118

Office: 739-0000 * Cell: 327-2319 * Fax: 645-2474

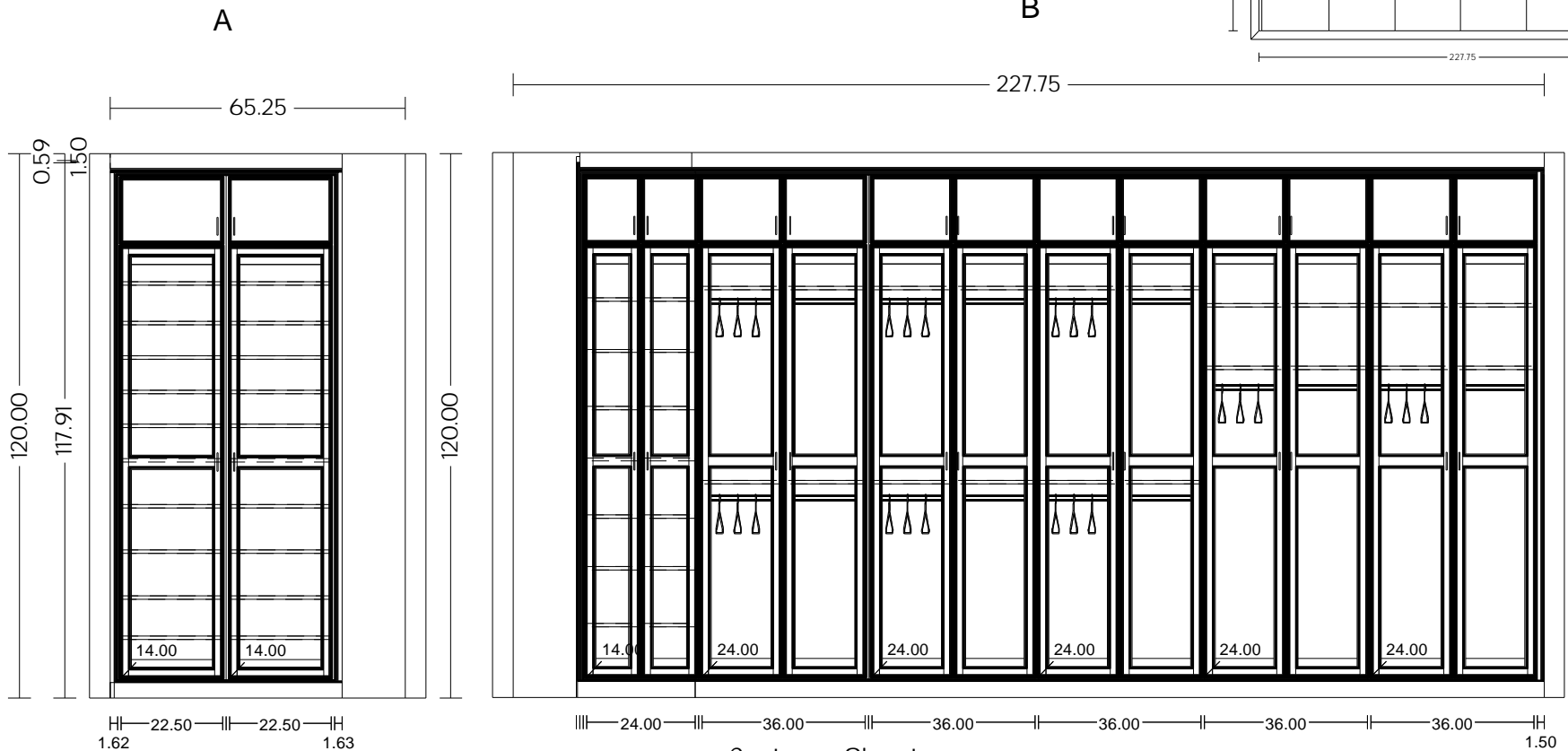

Customer Signature: _____



Design Team: Jay and Debbie Ward
 Factory Showroom
 5030 W. Oquendo Rd., Suite 100, Las Vegas, NV 89118
 Office: 739-0000 * Cell: 327-2319 * Fax: 645-2474

Dave and Kathy Oder
 Kathy's side of Island

These two cabinets are pass thru, and are suspended from the sides and ceiling.

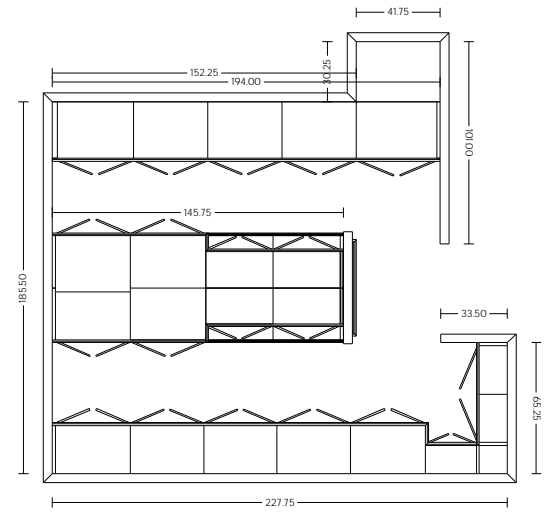

Customer Signature: _____



Design Team: Jay and Debbie Ward
 Factory Showroom
 5030 W. Oquendo Rd., Suite 100, Las Vegas, NV 89118
 Office: 739-0000 * Cell: 327-2319 * Fax: 645-2474

Dave and Kathy Oder

Dave's side of island

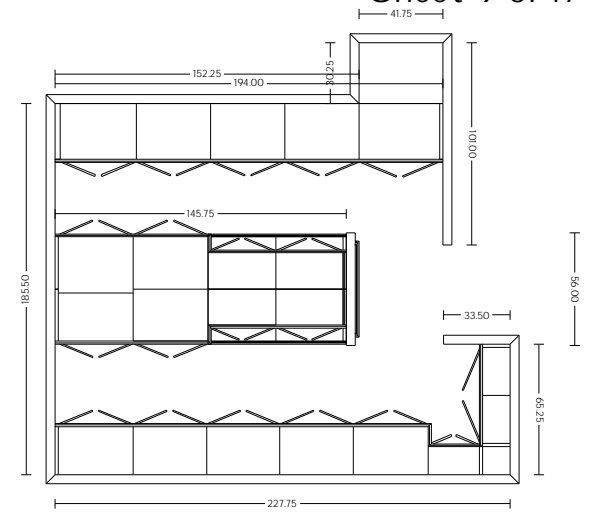
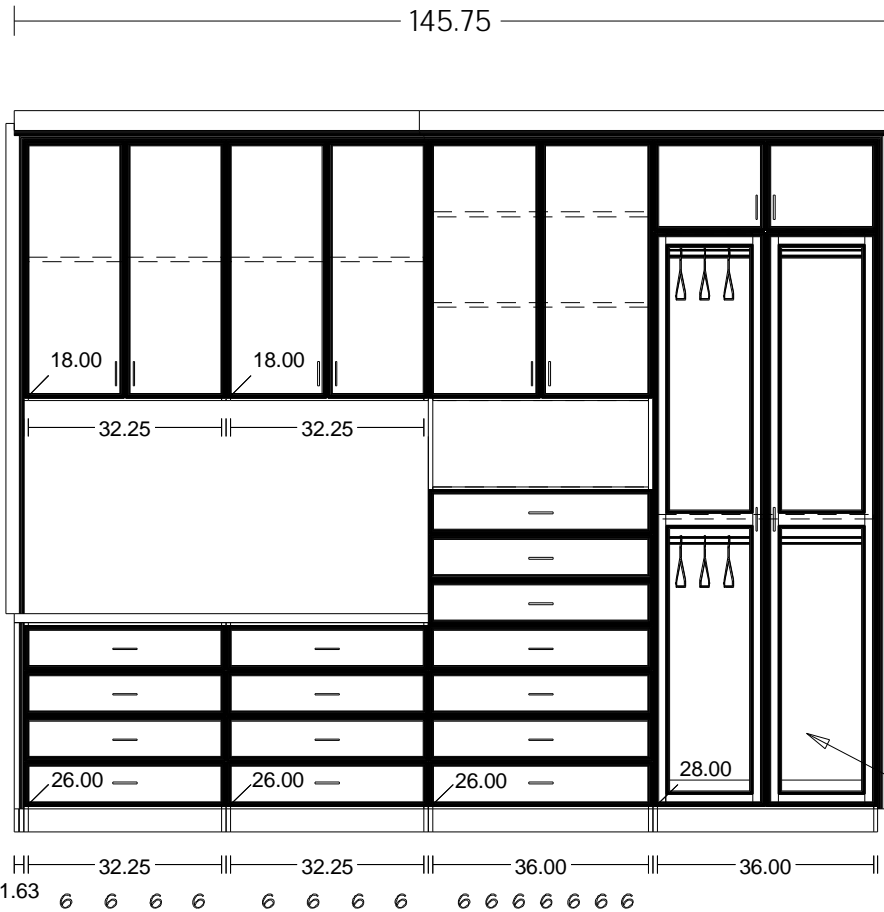

2.50 Top of rod to top of cabinet

44.20 Top of shelf to top of rod

2.89 Bottom of shelf to top of rod

44.60 Top of rod to floor of cabinet

Note that this cabinet is 28" deep, and the one behind it is 24" deep, so the centers will be offset to her side so face of wardrobe cabinet lines up with face of drawer cabinet

Customer Signature: _____



Design Team: Jay and Debbie Ward
Factory Showroom
5030 W. Oquendo Rd., Suite 100, Las Vegas, NV 89118
Office: 739-0000 * Cell: 327-2319 * Fax: 645-2474

Dave and Kathy Oder

Daves side of closet, wardrobe cabinets

The back to this cabinet slides to left behind adjacent cabinet to reveal cubby for safe. Clear opening should be 27", with 1" of door protruding into opening to help shut it. The fact that this back slides should not be readily evident. Maintain 26" clear depth or more in both cabinets. Safe will be in before installatio of cabinetry. Trim safe to walls for finished look.

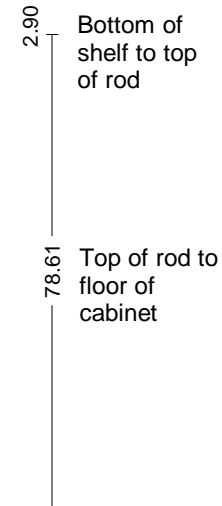
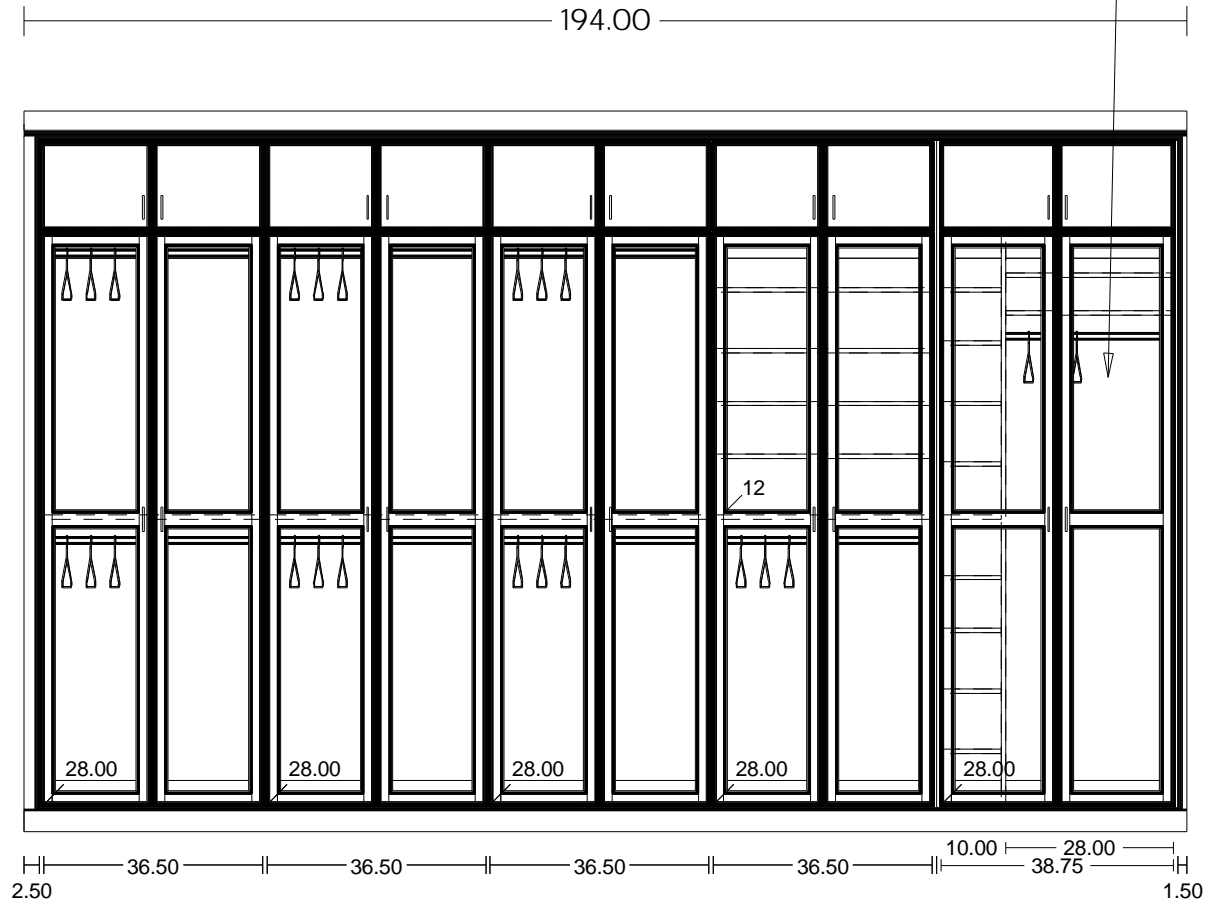
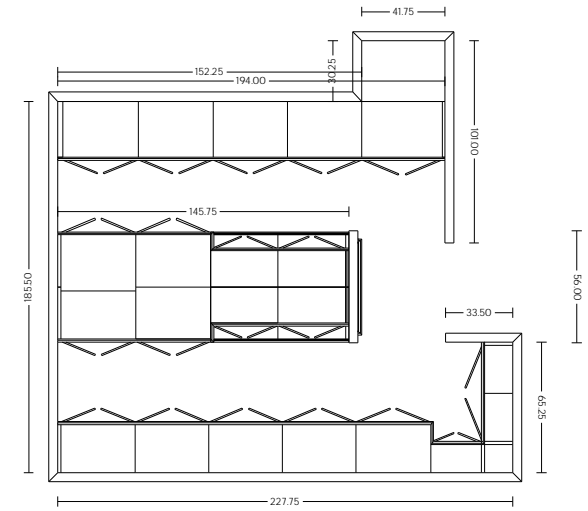

Customer Signature: _____



Design Team: Jay and Debbie Ward
Factory Showroom
5030 W. Oquendo Rd., Suite 100, Las Vegas, NV 89118
Office: 739-0000 * Cell: 327-2319 * Fax: 645-2474

Dave and Kathy Oder

Guest closet #1

Woodgrain melamine, deluxe edges, melamine slab
drawer faces and hamper door.

Include backs in cabinets



71.25

81.50

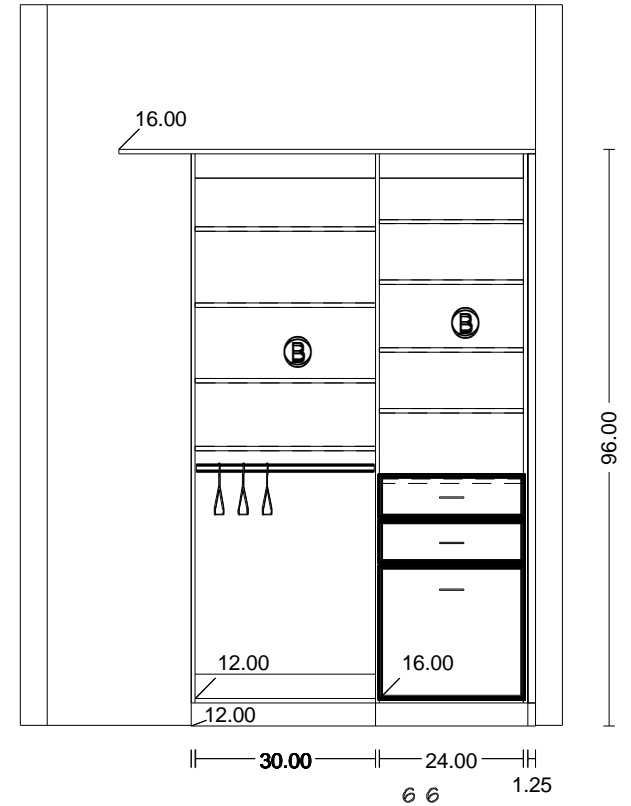
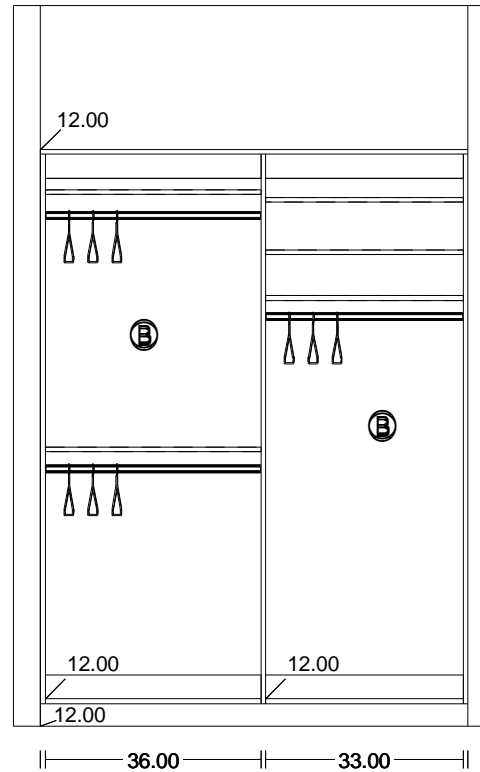

Customer Signature: _____



Design Team: Jay and Debbie Ward

Factory Showroom

5030 W. Oquendo Rd., Suite 100, Las Vegas, NV 89118

Office: 739-0000 * Cell: 327-2319 * Fax: 645-2474

Dave and Kathy Oder

Guest closet #2

Woodgrain melamine, deluxe edges, melamine slab drawer faces and hamper door.

Include backs in cabinets

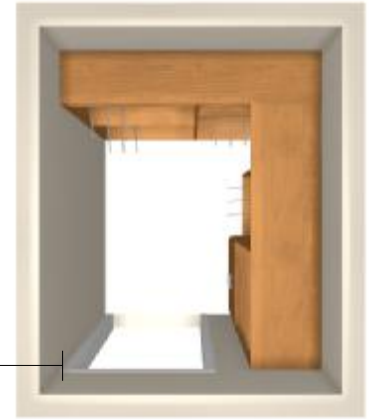

59.00

71.50

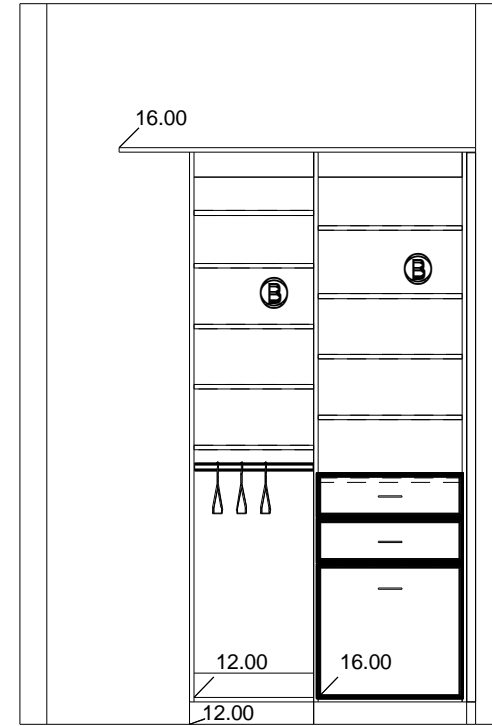
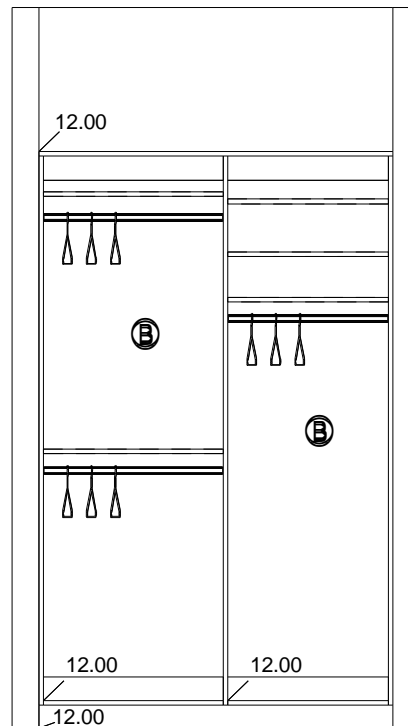

96.00

30.00 26.75

20.00 24.00 1.50
6 6

Customer Signature: _____



Design Team: Jay and Debbie Ward
Factory Showroom
5030 W. Oquendo Rd., Suite 100, Las Vegas, NV 89118
Office: 739-0000 * Cell: 327-2319 * Fax: 645-2474

Dave and Kathy Oder

Coat Closet

Woodgrain melamine, deluxe edges.

Backing in cabinets



71.25

78.00



96.00

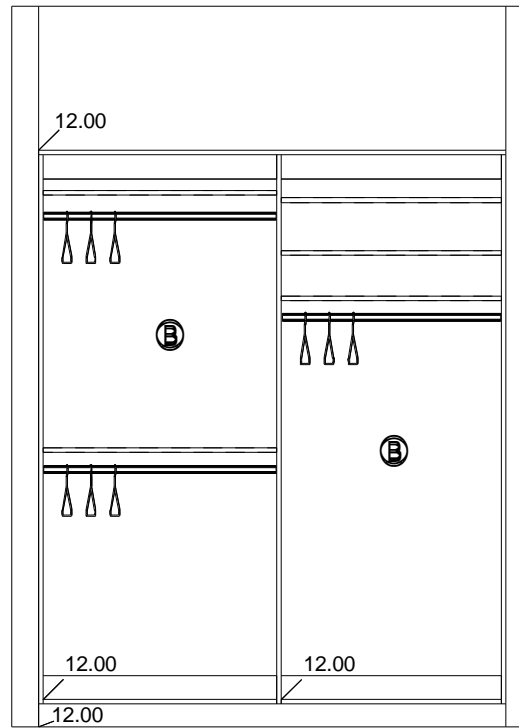

Customer Signature: _____

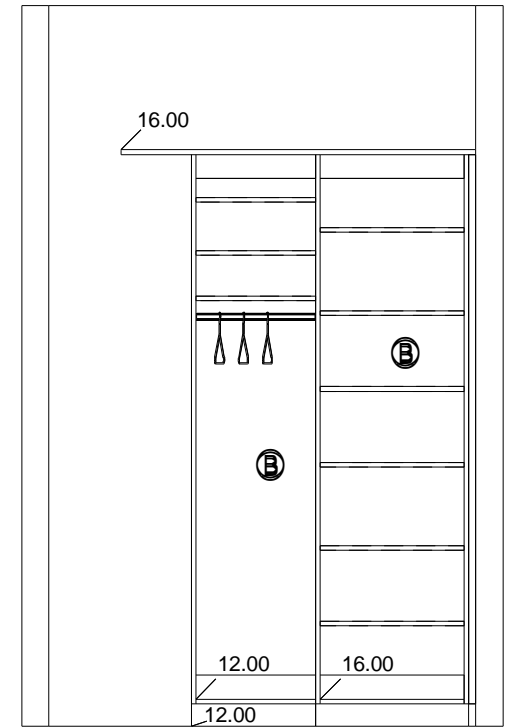

Design Team: Jay and Debbie Ward
Factory Showroom
5030 W. Oquendo Rd., Suite 100, Las Vegas, NV 89118
Office: 739-0000 * Cell: 327-2319 * Fax: 645-2474

Dave and Kathy Oder

Garage cabinetry

Build 24" deep except as noted on back left corner cabinet. Build to ceiling.

White exteriors and interiors.

Adjustable shelves

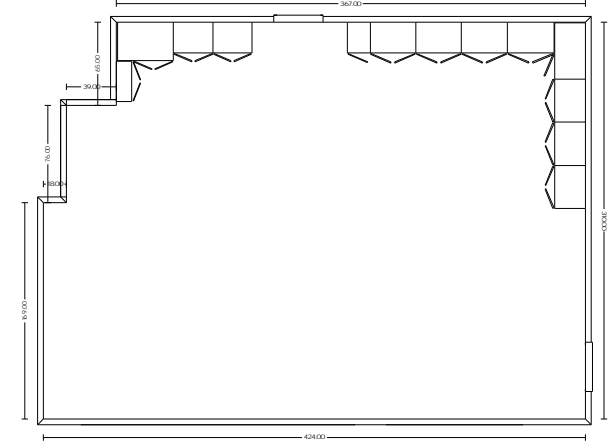

This cabinet is 30" deep to get past water access panel. Notch side to allow access to water valve and fittings.



Customer Signature: _____



Design Team: Jay and Debbie Ward
Factory Showroom
5030 W. Oquendo Rd., Suite 100, Las Vegas, NV 89118
Office: 739-0000 * Cell: 327-2319 * Fax: 645-2474

Dave and Kathy Oder

Garage storage elevations, sheet 1 of 2

Sheet 15 of 17

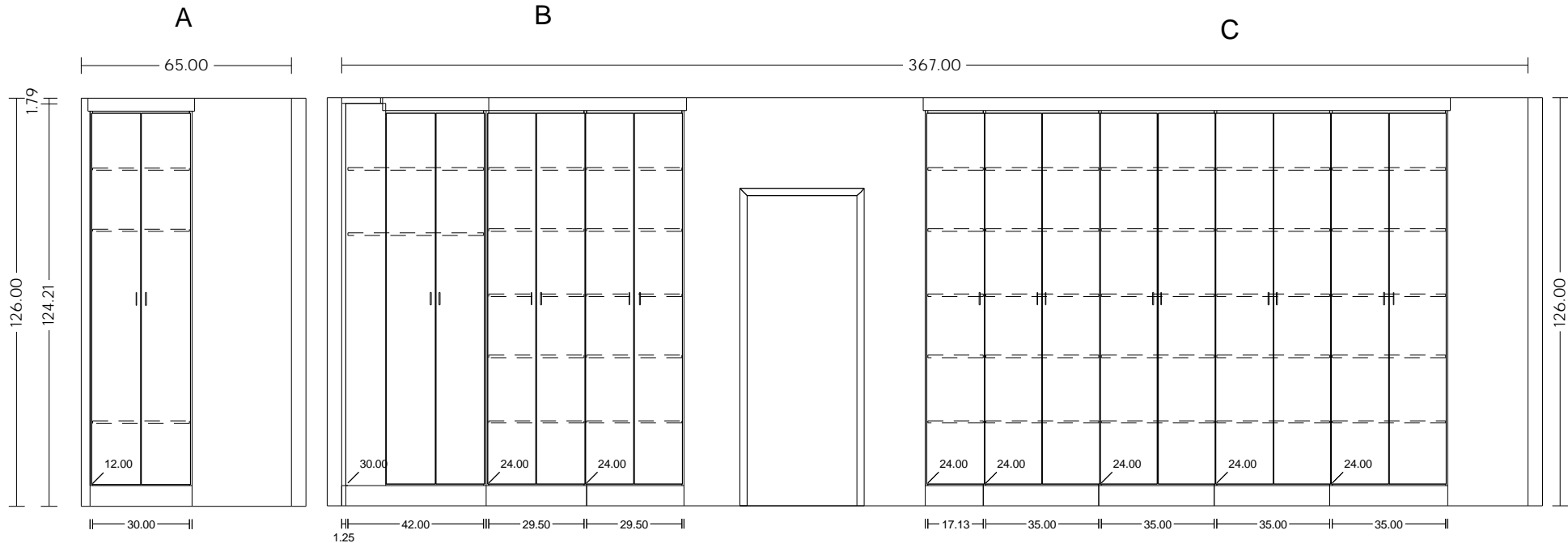
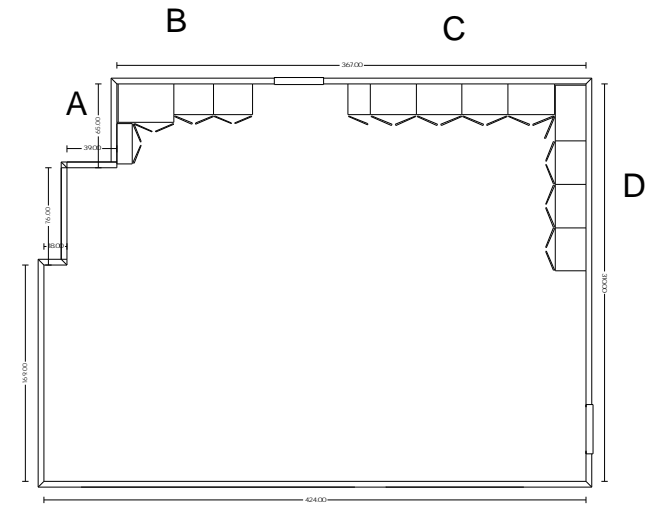

Customer Signature: _____



Design Team: Jay and Debbie Ward
Factory Showroom
5030 W. Oquendo Rd., Suite 100, Las Vegas, NV 89118
Office: 739-0000 * Cell: 327-2319 * Fax: 645-2474

Print Date: 05/13/06 J

Dave and Kathy Oder

Garage storage elevations, sheet 2 of 2

Sheet 16 of 17

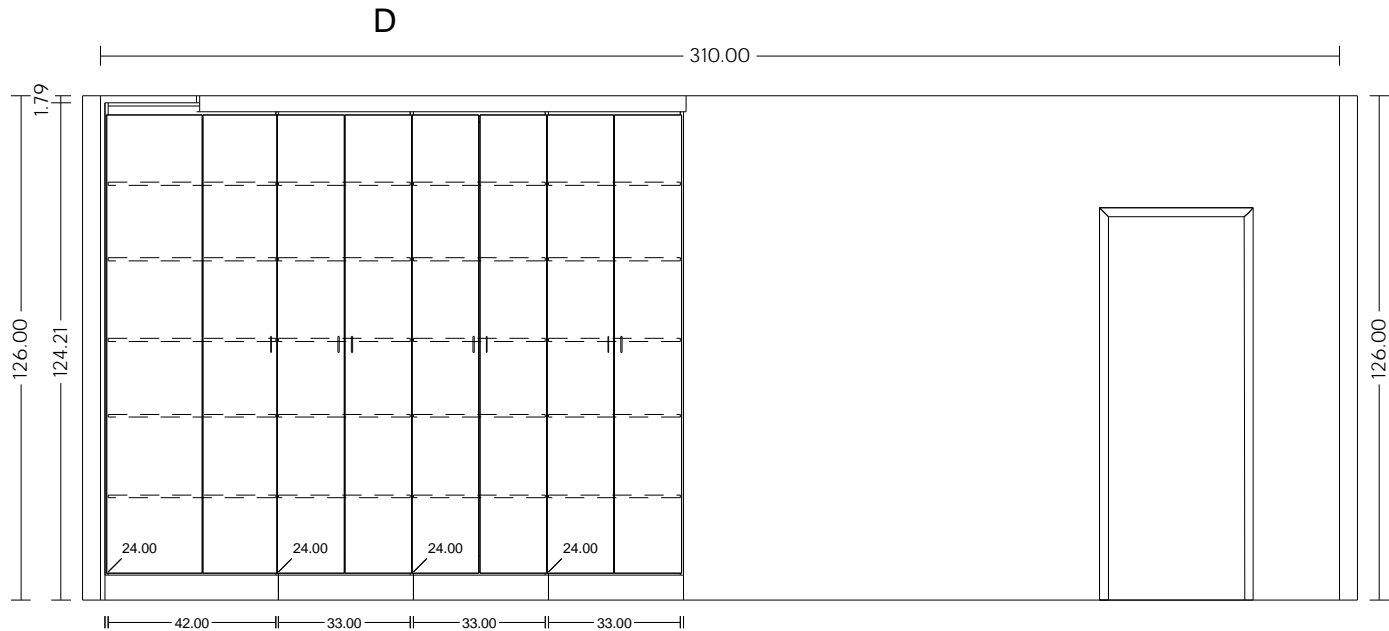
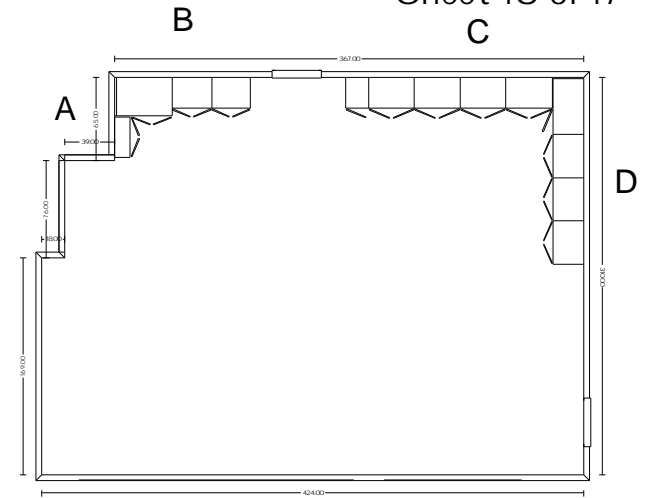

Customer Signature: _____



Design Team: Jay and Debbie Ward
Factory Showroom
5030 W. Oquendo Rd., Suite 100, Las Vegas, NV 89118
Office: 739-0000 * Cell: 327-2319 * Fax: 645-2474

Print Date: 05/13/06 J